

BUSINESS UNITS

FOR SALE - ONLY £200,000 PER UNIT

- High Quality Business Units
- Unit sizes from 1,250 sq. ft.
- Suitable for a variety of uses
- Flexible size and configuration
- Petrol Filling Station, Convenience Retail and Coffee Drive 'Thru' coming soon
- Well-connected location
- 2 minute drive to the AWPR
- LBTT paid and 100% small business rates relief available
- Available Q4 2018



The Place to do
BUSINESS



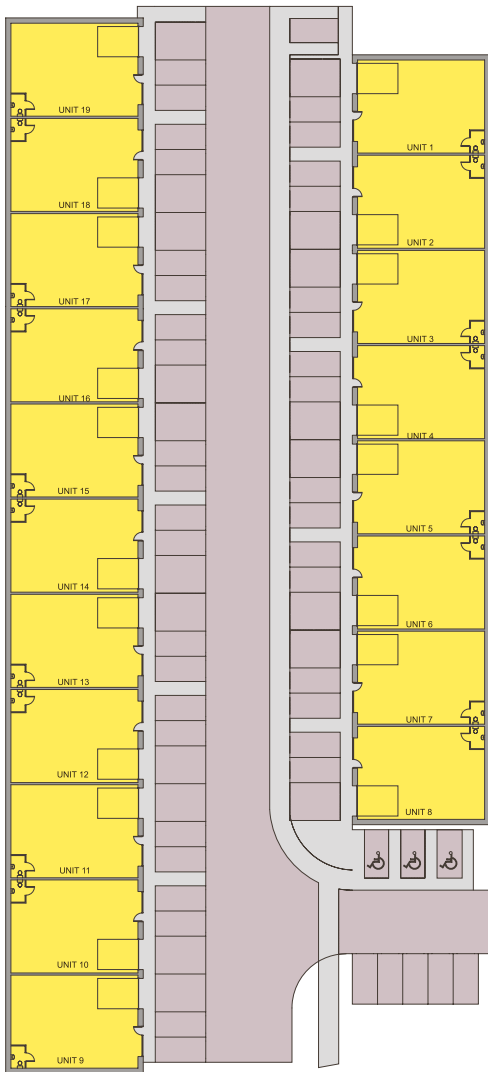

Typical unit size 9.17M x 12.66M



CBRE

Derren McRae
derren.mcrae@cbre.com
01224 219 000

Iain Landsman
iain.landsman@cbre.com
01224 219 000

FG Burnett

Jonathan Nesbitt
jonathan.nesbitt@fgburnett.co.uk
01224 572661

Graeme Nisbet
graeme.nisbet@fgburnett.co.uk
01224 572661

A development by
dandara

FEB2018